

# SECURITY

Protect your information and keep your office environment secure.



**bizhub 225i**  
**bizhub 205i**

A3 Monochrome Multifunctional Printers

## SMTP Authentication

This security tool enables the sending of documents via e-mail with authentication by an SMTP enabled server. Ideal for smaller offices without a private e-mail server, a connection to an SMTP enabled server allows SSL communication, so e-mails can be sent in a security-conscious state.

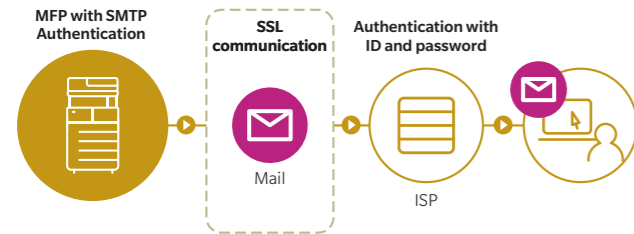

## Watermark Your Documents

Ensure your documents are clearly labelled to help prevent them falling into the wrong hands. Choose from a range of watermark options to suit the purpose of your document.

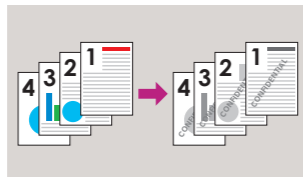

## Account Tracking

Enable Account Track on your bizhub to require a three-digit account number to use the Copy feature. This prevents unauthorized users from using the bizhub and tracks the volume of copying done by each account.

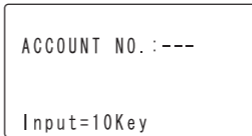

## Secure Print

When you enable this option, a password is required at the bizhub itself before a document will print. Set the password via the print driver at your computer, then enter it on your bizhub's control panel to start the print job. This prevents confidential documents from lying around the office or being accessed by an unauthorized user.



\*Passwords can be set in the range 0000~9999.

# bizhub 225i / 205i

Product appearance, configuration and/or specifications are subject to change without notice.

This product is not available for some countries or regions.

KONICA MINOLTA, symbol mark, Giving Shape to Ideas, bizhub, Konica Minolta Optimised Print Services logo and bizhub SECURE logo are registered trademarks or trademarks of KONICA MINOLTA, INC. KONICA MINOLTA, symbol mark, Giving Shape to Ideas, bizhub, Konica Minolta Optimised Print Services logo and bizhub SECURE logo are registered trademarks or trademarks of KONICA MINOLTA, INC. in the U.S. and other countries. Mac and App Store are registered trademarks or trademarks of Apple Inc. in the U.S. and other countries. iOS is a registered trademark or trademark of Cisco Systems, Inc. in the U.S. and other countries. Mopria and Mopria logo are registered trademarks or trademarks of Mopria Alliance Inc. Bluetooth is a registered trademark or trademark of Bluetooth SIG, Inc. Wi-Fi is a registered trademark or trademark of Wi-Fi Alliance. Microsoft Store, Windows Mobile and Power Point are registered trademarks or trademarks of Microsoft Corporation in the U.S. or other countries. Bitdefender logo is a registered trademark or trademark of Bitdefender IPR Management Ltd. All other brands and product names are registered trademarks or trademarks of their respective companies or organisations.



From consulting, system design, to operations, Konica Minolta offers total support to optimise your office output environment.

### Requirements for safe use

- Please read and follow the instruction manual to ensure safe operation.
- Only operate using appropriate power supply and voltage.
- Connecting the earth wire to an inappropriate place may cause explosion or electric shock. Please connect accordingly (Taiwan and the Philippines only).

Konica Minolta Business Solutions Middle East DMCC  
Jumeirah Lakes Towers, Dubai, UAE  
P.O. Box 338322  
For more information please call: +971 4 8808388 or  
email: marketing-me@konicaminolta.com



**225i** BW 22 PPM  
**205i** BW 20 PPM

Giving Shape to Ideas

# CONTROL PANEL

Easy to understand and easy to use.  
One touch buttons for speedy operation.

## Get to the Point

Find your way around in moments with an intuitive layout and large buttons. Useful functions such as ID Print and Duplex Copy have been assigned their own hard keys, so there's no need to scroll through menus to find what you need.

## Backlit LCD Screen

The five-line, backlit LCD display helps you problem solve quickly. Clear error indications and illustrated guidance assist you with problem solving, so you can get your machine working again as soon as possible.



# COPY & PRINT

Plenty of useful layout options to keep your documents organised.

## Handy Booklets

Easily collate your multi-page documents into a booklet with Booklet Print.



## Get Everyone on the Same Page

Print multiple pages onto one sheet with N-up Print. Collate 2 or 4 pages into one.

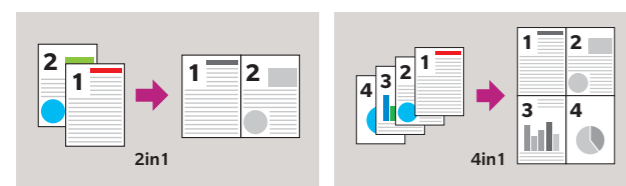

## Double Up

The optional Auto Duplex Unit (AD-509) enables Duplex Print and Duplex Copy for double-sided printing, helping you save paper.



## Can I See Your ID?

Combine both sides of small or irregularly shaped documents onto one page with the ID Copy function. With its own designated button on the control panel, you can create scans or copies in moments.

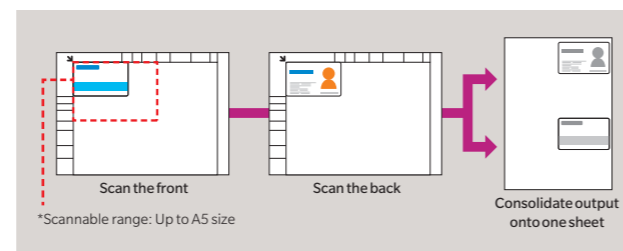

With the Multi ID Copy function, you can scan multiple small documents at once, neatly combining the fronts and backs onto a single sheet. Ideal for business cards.

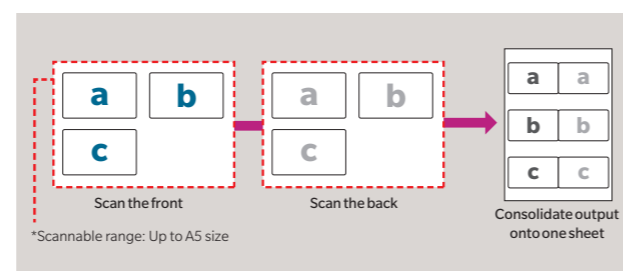

## Linux support

Output from a Linux environment is also available.

Supported Linux OS	Red Hat Enterprise Linux 5 (CUPS Ver1.2.4) x86	Enterprise Desktop 11(CUPS Ver1.1.23) x86
	Red Hat Enterprise Linux 5 (CUPS Ver1.2.4) AMD64/Intel64/SUSE Linux	SUSE Linux Enterprise Desktop 11(CUPS Ver1.1.23) AMD64/ Intel64

# SCAN & FAX

Digitise your documents in full colour and send them straight to where you need them.

## Scan Double-sided

The optional Reverse Auto Document Feeder (DF-633) makes double-sided scanning easy. Multi-page, double-sided documents are scanned with the pages in order, keeping your digital files organised and saving you time manually re-ordering documents after scanning.

## Scan in Full Colour

Digitise your documents quickly and easily. Scan up to 20 pages per minute\* in full colour, and choose what format you wish to store them in, including JPEG, PDF or TIFF.

\*20 ppm is the speed when equipped with optional Reverse Automatic Document Feeder DF-633

## Select Your Destination

Once your documents are scanned, you can send them to the desired destination directly from your bizhub. Store files straight to a USB storage device via the USB port, send them via e-mail, SMB or to an FTP server.

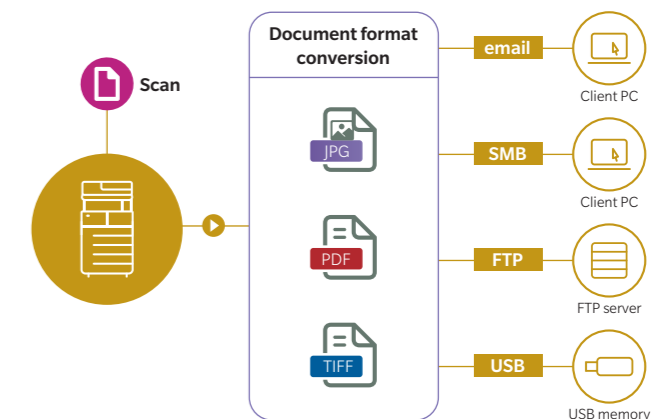

## Sent in Seconds with G3 Fax

With the addition of the optional Fax Kit (FK-510) and Fax Panel (MK-750) you can send faxes in as little as 3 seconds via high-speed G3 faxing. A variety of faxing options are available allowing you to select the ideal format for your document. Select Super Fine image quality for high quality transmission and choose from multiple paper sizes.

## Internet Fax

Save on running costs by using Internet Fax to send your documents via your existing internet connection. Ideal for office spaces where fax is a necessity, but not in use every day. Requires optional Fax Kit (FK-510) and Fax Panel (MK-750).

# MOBILE PRINT

No need to waste time transferring documents to your office computer for print. Work on-the-go and stay on-the-go.

## Mobile Print for bizhub 205i/225i

Our Mobile Print for bizhub 205i/225i app allows you to print directly from your Android or iOS device. The simple and intuitive app interface makes it easy to select and send documents and photos on your device and send them directly to your bizhub.

\*For Android devices download from the Google Play Store. For iOS devices download from the App Store.

