

# bizhub i-SERIES

RETHINK IT



## bizhub C4050i / C3350i

Product appearance, configuration and/or specifications are subject to change without notice.

This product is not available for some countries or regions.

KONICA MINOLTA, symbol mark, Giving Shape to Ideas, bizhub, Konica Minolta Optimised Print Services logo and bizhub SECURE logo are registered trademarks or trademarks of KONICA MINOLTA, INC. Android, Google, and Google Cloud Print are registered trademarks or trademarks of Google Inc. in the U.S. and other countries. Mac and App Store are registered trademarks or trademarks of Apple Inc. in the U.S. and other countries. iOS is a registered trademark or trademark of Cisco Systems, Inc. in the U.S. and other countries. Mopria and Mopria logo are registered trademarks or trademarks of Mopria Alliance Inc. Bluetooth is a registered trademark or trademark of Bluetooth SIG, Inc. Wi-Fi is a registered trademark or trademark of Wi-Fi Alliance. Microsoft Store, Windows Mobile and Power Point are registered trademarks or trademarks of Microsoft Corporation in the U.S. or other countries. Bitdefender logo is a registered trademark or trademark of Bitdefender IPR Management Ltd. All other brands and product names are registered trademarks or trademarks of their respective companies or organisations.



From consulting, system design, to operations, Konica Minolta offers total support to optimise your office output environment.

### ⚠ Requirements for safe use

- Please read and follow the instruction manual to ensure safe operation.
- Only operate using appropriate power supply and voltage.
- Connecting the earth wire to an inappropriate place may cause explosion or electric shock. Please connect accordingly (Taiwan and the Philippines only).

Konica Minolta Business Solutions Middle East DMCC  
Jumeirah Lakes Towers  
Dubai, United Arab Emirates  
Tel. No. +971 4 880 8388  
PO Box 338322  
[www.konicaminolta.com/me](http://www.konicaminolta.com/me)



**C4050i**  
Colour 40 PPM  
BW 40 PPM

**C3350i**  
Colour 33 PPM  
BW 33 PPM

# TOMORROW'S WORKPLACE TODAY

## A NEW WAY OF WORKING HAS ARRIVED

### From an office hub to a partner that enhances your creativity.

As office documents become more digitised and data volumes increase, document management and access assume more importance than ever. Remote access and cloud integration also heighten the need for security.

Multifunctional Printers (MFP) are now expected to connect people, places and devices simply and safely and create a new way of working.

We want to provide a new-value office that can be used intuitively by digital natives. That intent gave rise to the 2<sup>nd</sup> generation bizhub, the bizhub i-Series.

MFPs have transitioned from an office hub to “a partner that enhances your creativity”, one that meets your diverse workstyles and business needs.

Why not embrace this smarter, simpler way of working?



## “i” changes the office of the future from a customer perspective

### From an executive's perspective

Konica Minolta supports corporate governance through our services

### From an IT manager's perspective

Assures IT security and reduces managerial burden

### From a user perspective

Prioritising the User Interface for simplicity and ease of use

## Delivering Simple, Secure and Convenient office work We innovate your business, processes and way of working



### Simplifying work

The operation panel design has been updated to reflect familiar smart device operation. It offers the user a smarter way of working.

### Thoroughly protecting office information

Improved security of large-volume office data, and paper documents, significantly reduces the burden on IT managers.

### Always at the forefront

Konica Minolta's remote service support governance and resolve executive concerns and issues.



**i-SERIES  
SIMPLE**

# SIMPLIFYING WORK



The User Interface has been completely revamped with an operation panel screen with smart-device-style operability. Operation has been simplified by narrowing down functions and screen transitions to frequently-used functions.



### User friendly, large 10.1-inch touch panel

The 10.1-inch panel has been newly developed from the customer's perspective. It delivers better legibility and ease of operation for enhanced work efficiency. The multi-touch feature enables smooth, intuitive tablet-like operation.

### Adjustable tilt operation panel

The operation panel can be freely tilted to a maximum 90° to suit individual users. Movement is stiffer when tilting backwards, to accommodate touch panel use, while it can be smoothly adjusted with light pressure when tilting forward.

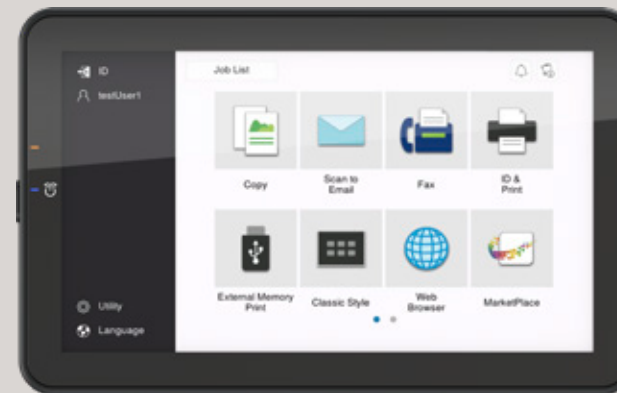

### Panel vibration assists operation

Touching the panel triggers vibration feedback, assisting panel operation by users who are visually impaired.

### Indicator lights

bizhub C4050i has adopted new LED lights that gently harmonise with the office environment. The LEDs are located in front of the MFP. Data light indicates data receipt or accumulation, and print light reminds users to collect the document from output tray.

### Voice guidance

Voice guidance offers support such as reading out fax numbers, explaining major screens and keys, and key-related operations. It also assists panel operation and prevents mis-operation.

\*This function is only for use in enlarged displays on copy, fax and scan screens.  
\*Requires i-Option LK-104 v3, and device connection I/F kit EK-P08 or EK-P09.

### Colour Universal Design

Konica Minolta has acquired Colour Universal Design certification from Japan's Colour Universal Design Organization (CUDO).

\*In validation tests using subjects with four types of colour-vision deficiencies, (red and green blindness, red and green weakness), CUDO confirmed that regardless of the deficiency, information transmission in colour by this unit functioned correctly.



### Easy-to-use, new operation panel design

The operation panel features a new simple GUI (Graphical User Interface) design. Features including no hard keys and panel vibration feedback reflect familiar smart devices and enable easy use of a variety of IT services. Simplicity of operation has been achieved by concentrating on frequently-used functions to minimise functions and screen transitions.



**Home screen**  
The screen is broadly divided into an Information Area and a Main Area

- Information Area: displays information such as settings menu buttons, ID button, and user name while logged in.
- Main Area: access to functions such as copying, faxing and scanning.

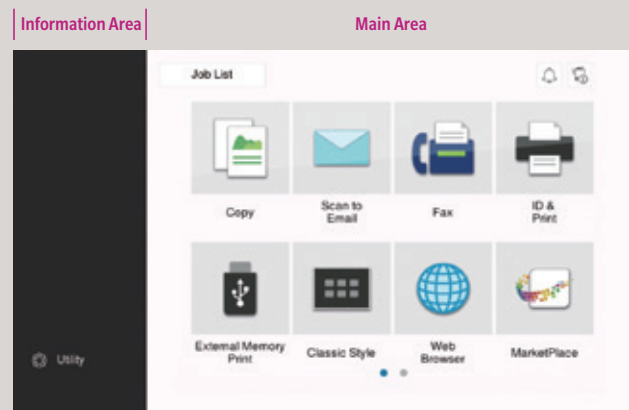

**Scan screen**  
Scan screen easily executes the intended task with minimal screen transitions

- Refined functions: displays only carefully selected often-used office functions
- Pop-up settings: minimisation of screen transitions allows the user to concentrate on intended task.

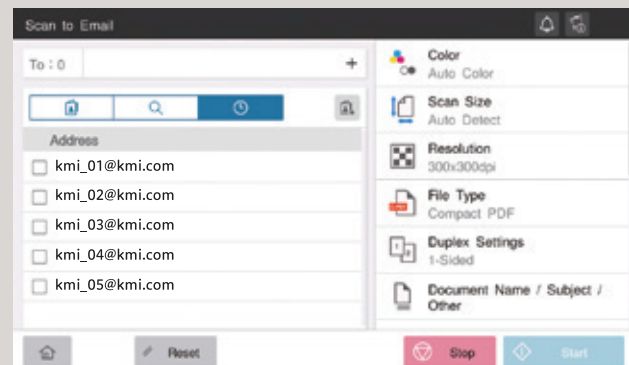

### Switchable GUI operation panel with a choice of two panel styles

The user can switch between two panel styles as required: the new GUI Basic Style characterised by simple operation, and the conventional Classic Style utilising advanced settings and functions.

### Compact design

bizhub C4050i has a compact footprint of 420 mm width and 528 mm depth. Compared to its predecessor, width has been reduced by about 25% and depth by about 11%. Its size lends itself to use in settings such as corporate back offices, deskside in small home offices, or as a departmental machine in large offices.



**i-SERIES  
SECURITY**

# THOROUGH PROTECTION OF OFFICE INFORMATION



User authentication, the cloud, and a variety of document data security functions lighten the burden on IT managers facing security issues with large-scale digital data and paper documents.



**bizhub SECURE services**

Data protection is a major issue for most companies. bizhub delivers advanced security settings through bizhub SECURE services, a total security setting service that provides greater protection for customer data stored in the SSD and device's network settings.

**CS Remote Care**

CS Remote Care is an advanced remote diagnostic and management platform that prevents, or swiftly responds to breakdowns to minimise machine downtime. Automatic data transmission of counter readings further simplifies management. Automatic reporting of breakdowns and managing the status of parts and consumables enable provision of support without bothering the user, and high-grade after-care, including automatic dispatch of toner as required.

\* For more information, please contact your authorised Konica Minolta retailer.

**Encrypted SSD**

bizhub C4050i series adopts a new 256GB encrypted SSD for heightened security functions. With very few device compatibility problems, and with full-time encryption, this constantly maintains a high level of security with no fuss.

**Secure printing**

By setting a password for documents on the printer driver screen, the document is stored on the unit's SSD until the same password is input into the unit's operation panel. The document is protected without being output until the password set for that document is matched. This is useful when you wish to output a vital document or give permission for limited users to receive copies.

**Various types of user authentication**

Optimal authentication systems can be customised to suit office scale and pre-existing systems. bizhub C4050i series also supports single sign-on (SSO) which enhances operability without sacrificing security.

**Main unit authentication**

Authentication can be performed through the bizhub alone. It is also possible to set detailed usage restrictions for functions, including copy, print, scan and fax.

**Non-contact IC card authentication**

Non-contact IC cards<sup>1</sup> such as FeliCa can be used to authenticate users<sup>2</sup>. This also supports SSFC (Shared Security Formats Cooperation) specifications which enable integration of staff authentication with authentication systems. Apart from non-contact IC cards, authentication can also be carried out on NFC-compatible Android devices<sup>3</sup>.

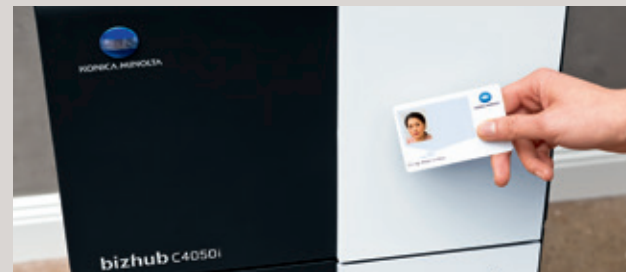

<sup>1</sup> Non-contact IC cards are compatible with FeliCa (IDm), SSFC, FCF, FCF (Campus) and MIFARE (UID).

<sup>2</sup> Requires the IC card authentication device AU-201S option.

<sup>3</sup> Requires an Android device later than Android 4.4, compatible with HCE (Post Card Emulation), and Konica Minolta Mobile Print.

**Biometric authentication**

Highly accurate authentication is possible using finger veins. It's easy, and also enables the building of high-level security systems.

\*Requires the Biometric Authentication Devices AU-102, EK-P08 or EK-P09 and WT-P03 options.

**Virus scanning**

bizhub C4050i series is equipped with robust antivirus software based on an embedded BitDefender scan engine to ensure safe connection to the MFP by the cloud, and to devices including PCs, tablets, and USB flash drives. Scanning individual files means much finer virus detection than with the whitelist method alone. Latent viruses in the office are discovered through checking and notification when files are input. Checking when files are output from the MFP also prevents dissemination of infected files. Further periodic checking of files in the MFP discovers risky files and detects latent risks in the MFP. Real time virus scan jobs are available for print, scan and fax functions, while manual or scheduled virus scans are possible for Box and SSD such as SMB folders.

\*Requires i-Option LK-116.

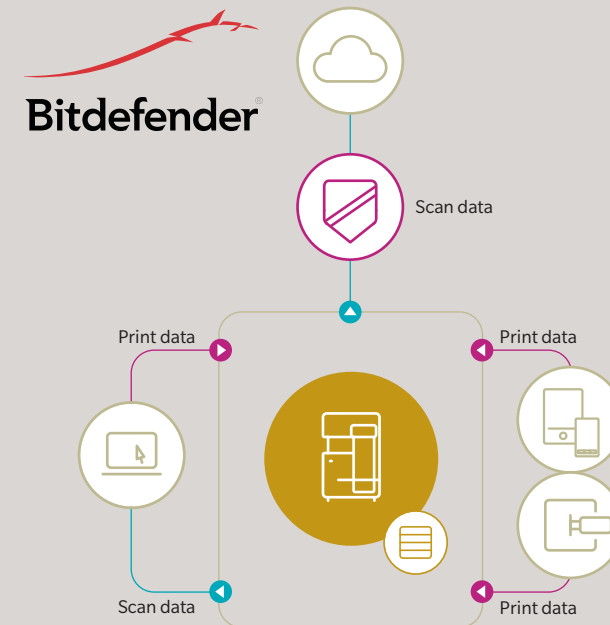

**Serverless printing in a ubiquitous network**

bizhub C4050i series achieves serverless printing in a ubiquitous network that outputs previously sent print jobs from any desired MFP in the office network, after authentication. As a base unit for printing, it works as a print server, which enables the easy, low-cost creation of a serverless printing system for ubiquitous computing.

\*A print system in a ubiquitous network can be created for up to 100 units.  
\*Each MFP requires the i-Option LK-114 option.

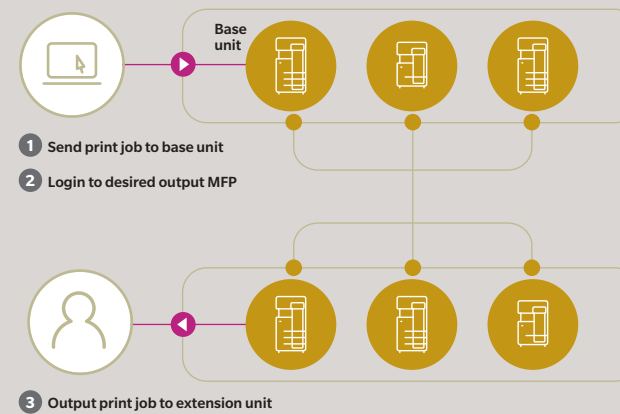

**Copy Protect Function**

To prevent unauthorized copying, the Copy Protect Function that imprints special text, such as "Confidential" and the date, in an inconspicuous way in the background are available with bizhub C4050i series. This prevents leakage of unauthorised secondary copies and vital documents to third parties.

**Encrypted PDFs**

• **Password encryption**

Documents distributed in PDF form can be password encrypted.

• **Digital ID encryption**

Only authorised recipients with a private key can decrypt. This ensures a far more robust level of security than the previous public key system.

\*If encrypting with Digital ID, the email address (S/MIME send) to which the Digital ID has already been registered must be registered to the MFP's abbreviated address.

\*Requires the i-Option LK-102 v3.

• **Electronic signatures**

Electronic signatures certify (MFP) document authors, and also guarantee that the document has not been changed and is valid. Certifications by third party organisations can also be used.

\*When using electronic signatures, files should be encrypted using either a password or Digital ID.

\*Requires i-Option LK-102 v3.

**Recognised high-level security ISO/IEC 15408 certification**

To objectively prove reliability of Konica Minolta MFP security functions, we have obtained the Common Criteria (CC) for Information Technology Security Evaluation (ISO/IEC 15408). For bizhub C4050i we plan to obtain CC certification for compliance with HCD-PP v1.0 (Protection Profile for Hardcopy Devices).

\*Information security-related certification obtained for this product (and this system) demonstrates compliance with certification requirements as a result of evaluations based on specified evaluation standards and methods, but does not assure that the product (or the system) is completely without weaknesses.

**Other major security features**

- SMTP authentication/POP before SMTP authentication enable security to be set when sending emails.
  - SSL/TLS protocol enables encryption of data transmission between networks
  - Storage Lock Password prevents unauthorised access to the SSD
  - TPM (Trusted Platform Module) safely manages confidential information
- \*Optional.

**FASEC 1-compliant fax security**

- Double Address Input prevents mistaken transmission through input error
- Destination Number Confirmation Display prevents mistaken transmission due to incorrect button pressing
- Dial Tone Detection function prevents mistaken transmission due to call collision
- Memory Receive & PC Forward prevents paper faxes from being left behind
- Transmission Result Report and Operation Panel Result Check enables checking the certainty of the transmission

**Konica Minolta's original fax security**

- Send Approval Password function prevents mis-transmission through thorough checking
- Recipient Confirmation (CSI matching) Send prevents mis-transmission through mistaken connection
- Voice Guidance when Sending uses voice guidance to prevent mis-transmission

\*optional

- Designated Tray Paper Feed assists security management



**i-SERIES  
SUSTAINABILITY**

# ALWAYS AT THE FOREFRONT

Konica Minolta remotely manages bizhub operating conditions and toner levels, and delivers a variety of support and cloud services including automatic firmware updates and remote monitoring.



### Worldwide Remote Service Platform

We developed new services leveraging IoT so users can focus on their core business. i-Series intelligently collects data for self-diagnostic and remote maintenance, as well as predicts the optimum replacement time for parts and consumable to minimise downtime.

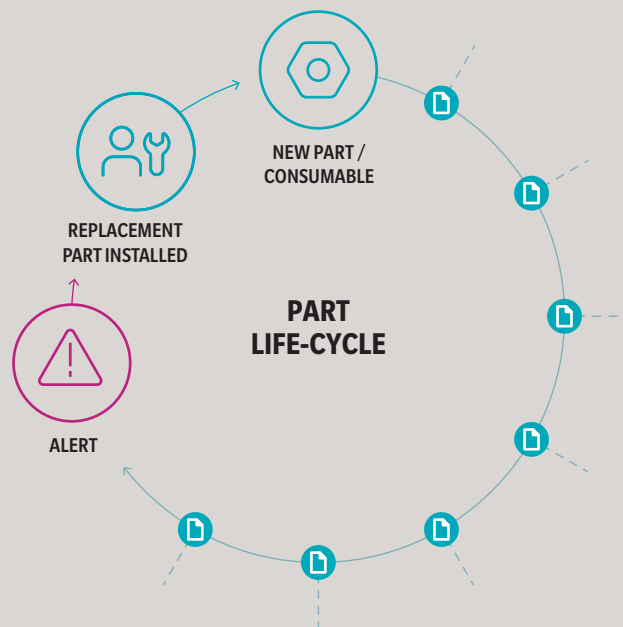

**D** --- Data collected for part/consumable replacement predictions

\* For more information, please contact your authorised Konica Minolta retailer.

### Animated guide

The animated guide demonstrates procedures such as handling paper jams and replenishing consumables. Following the instructions displayed on the operation panel ensures smooth operation.

### Web browser function

bizhub C4050i series supports a web browser function. Websites can be displayed on the operation panel and printed out. Pages in PDF files on the website can be specified and only the required sections printed. This is very handy, allowing easy printing such as of destination maps from the site.

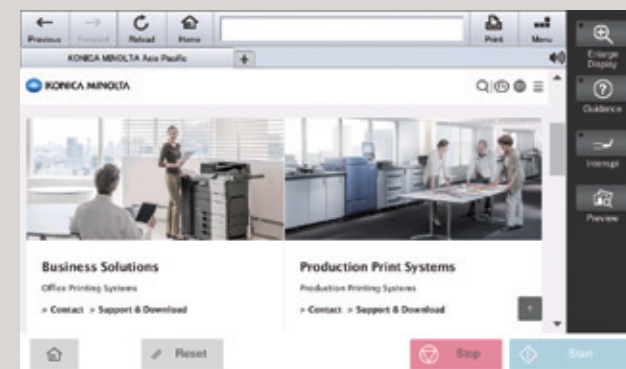

### bizhub Connectors

The operation panel connects to various cloud services<sup>\*1</sup> and corporate internal server SharePoint 2007/2010/2013/2016, enabling connectivity for scan data uploads or direct printing. After logging in to the bizhub, users can also automatically log in under silent mode by entering and saving authentication information to services such as the cloud.

#### bizhub Connector<sup>\*2</sup> offers 3 applications

**bizhub Connector S-1** for Microsoft SharePoint

**bizhub Connector G-1** for Google Apps

**bizhub Connector E-1** Works with Evernote

\*1 Google Drive, Gmail, and Evernote.

\*2 Requires a separate set-up fee.

### High-performance quad-core CPU

A high performance Cortex A72 CPU Quad Core 1.6 GHz CPU improves overall system performance over the previous model's dual core, 1.2 GHz CPU. The extra CPU cores mean efficient parallel processing of applications, and seamless operation of cloud applications even during basic MFP's processing functions such as copying and printing.

### Shorter warm-up time

The warm-up time, from powering up to printing is kept within 13 seconds. First Copy Out Time, from when the copy button is pressed until the first copy prints, is 4.8 seconds or less. Panel reset time has also shortened greatly to about 1.5 seconds.

#### Warm-up time\* comparison between previous model and bizhub C4050i

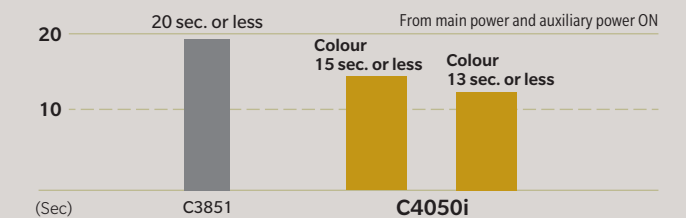

\* 23°C, at rated voltage

#### First Copy Out Time\* comparison between previous model and bizhub C4050i

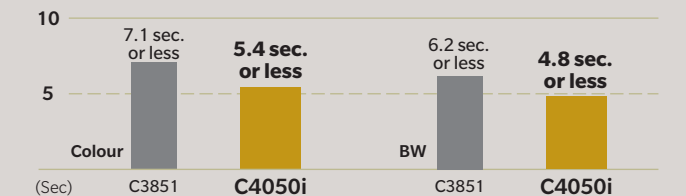

\*A4 horizontal, same scale, No 1 paper feed tray, importing from platen glass

#### Panel reset time comparison between previous model and bizhub C4050i

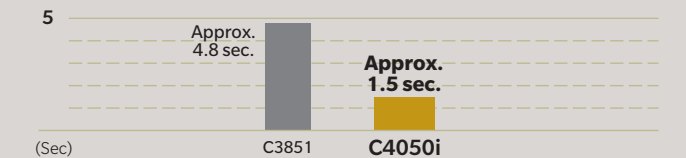

# COPY / PRINT

Equipped with advanced functions for colour MFPs.  
Both Copy and Print functions exhibit outstanding performance.

## High-volume paper input capacity

A 500-sheet large capacity paper feed unit and a 100-sheet multi-manual feed unit come as standard. Adding two optional 500-sheet paper feed units enables a maximum of 1,600 sheets\*. Further installing the optional off-line stapler removes the effort of manual stapling.

\*80 gsm paper



## Lightweight paper trays

Paper trays handle easily and open / close smoothly with a light press and pull motion. Trays can be removed for retrieval of jammed paper, which equates to less downtime.



## Enhanced 1,200 dpi resolution

bizhub C4050i series achieves a 1,200-dpi print resolution with superb ability to reproduce small font sizes and fine lines. Such faithful reproduction capability improves document legibility and produces beautiful, high-quality print-outs.

\*Slows down printing speed.

## Adoption of colour matching, corresponding to "memory colour"

Printer driver colour settings have been revised to perform colour matching corresponding to default "memory colour settings". "Memory colour settings" refer to colours that most people recall as being brighter and more saturated than reality. Konica Minolta's colour matching improves satisfaction with print quality by strongly appealing to people's colour memories.

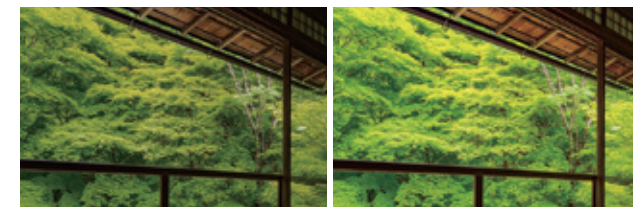

## Fast print speed up to 40 ppm

Colour and monochrome printing up to 40 ppm (A4 portrait) enhance business efficiency and productivity. Cabinets and castors can be further customised to suit the office environment and usage settings. Configurations can be freely customised, from A4 submachines in large offices to small home office and shop machines.

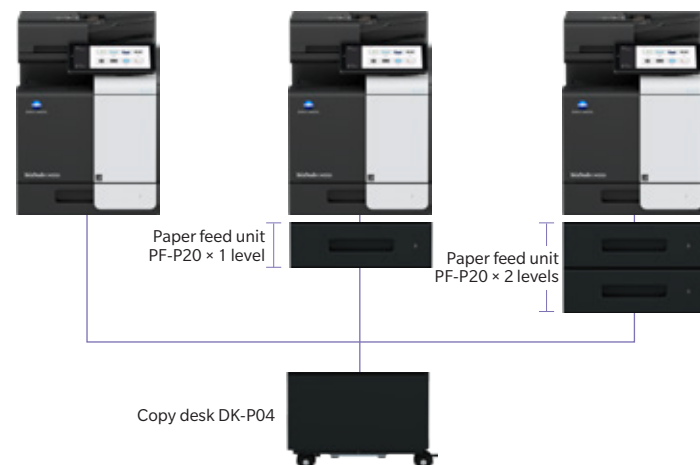

## Card Shot function

When copying both sides of an irregular-sized original such as a license or business card, the front and back sides of the card can be automatically arranged to be printed on the same side of one sheet.

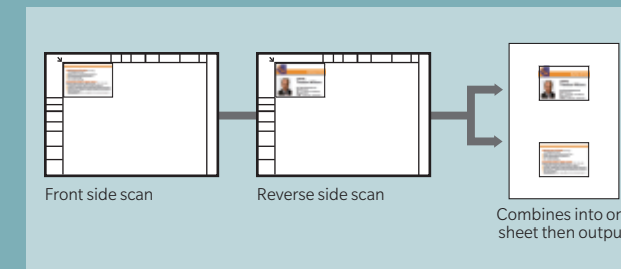

## Non-Image Area Erase function

When copying with the cover open, such as for thick books, the original is automatically detected and the shadowy area around the original is omitted. This saves excess toner consumption.

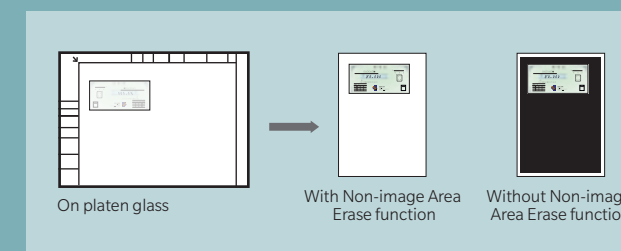

## Standard USB port

A USB port is standard equipment, located on the side of the main unit's operation panel. After inserting a USB flash drive, printing procedures pop up in the touch screen, and the flash drive data can be directly printed or saved to a box in the unit with a few easy steps.

\*May not operate correctly depending on the type of USB flash drive.

\*Supported file formats: PDF, compact PDF, JPEG, TIFF, XPS, compact XPS, and OOXML (.docx/.xlsx/.pptx).

\*Printing results may differ from the image on the PC screen.



## Supports VLAN (Virtual LAN)

bizhub C4050i series supports a VLAN function that splits multiple networks logically. Data can be isolated for each network, such as externally vs. internally connected networks, company dedicated vs. guest-only networks, or in offices occupied by multiple companies so the bizhub can be used securely.

\*For further details please contact your authorised Konica Minolta retailer.

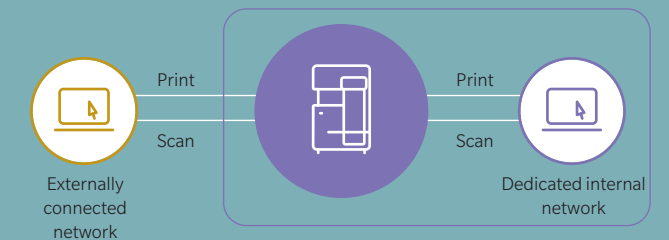

## Email RX Print

Files can be easily printed out by attaching them to an email and sending it to the machine's email address.

\*Supported file formats: PDF, Compact PDF, JPEG, TIFF, XPS, Compact XPS, and OOXML (.docx/.xlsx/.pptx).

\*Requires i-Option LK-110 v2.

## Other copy functions

- Image Quality Mode to match the original (text, text/photo, photo, faint original, map, copied original)
- Output Mode that matches application (double-sided printing, page aggregation, repeating, grouping, sorting, shifting, booklets, binding margin)
- Diverse Original Document Scan Modes (continuous scan, binding margin, original loading direction, programmed jobs, blank original removal)
- Copy Mode can be set according to objective (book original, consecutive page copying)
- Selectable Layout Adjustment (enlarge/reduce, consecutive enlargement copying, image storage method, mirror imaging, image shift)
- Handy Page Insertion (coversheet, insert sheet, chapter separator, insertion page)
- Expanding usage with Image Additions (date/time, page number, stamp, watermark, head/footer, overlay, registered overlay)
- Able to copy required sections only (Frame Erase, Erase Outside)
- Copy Protect Function that prevents unauthorized copying through inconspicuous background printing

## Other print functions

- My Tab Function can customize your own printer driver
- Carbon Copy Mode prints the original docket and copy at the same time
- Auto Trapping Function prints so that there is no white gap around images

\*Some functions are only compatible in Classic Mode.



# SCAN / FAX

The Scan/Fax functions deliver high performance and high functionality from speed, quality and distribution to storage.

## Outstanding scan performance

Automatic duplex, simultaneous scanning with an Automatic Document Feeder (ADF), achieves high-speed colour scanning of 90 ppm (45 double-sided A4 sheets per minute). Up to 80 sheets\* can be set at any one time, significantly reducing scanning time and effort. The precision of automatic skew correction, which adjusts the angle of the scanned original, has been greatly improved to deliver highly accurate scanning with less skew.

\*80 gsm

## Double feed detection sensor

Applying ultrasonic waves to the original distinguishes a layer of air between each page and detects double feeds. When a double feed is detected, a preview of the original that has already been scanned will be displayed so that the job can be restarted without repeating the whole scanning operation from the beginning.

\*Requires Upgrade Kit UK-P19 option.



## Paper Size Measurement function

This function automatically measures irregular-sized paper placed on the platen glass. The size of the measured paper can also be registered in the bizhub's memory. It can be utilised in offices that handle irregular paper sizes like slips and vouchers.

## Scan to URL function

Equipped with a Scan to URL function which stores Scan data within the bizhub, then emails the storage destination URL to the user. This enables easy transmission of large volume data that cannot be attached to emails.

## Box storage of received data promotes a paperless environment

Received fax data is automatically sorted according to TSI (Transmitting Subscriber Identification) and automatically stored in the bizhub's box. Setting automatic transfer to client PC or email addresses saves both effort and cost in sorting and distributing received documents. Forwarding to the bizhub's SMB shared folder is also possible. bizhub C360i series can also handle functions such as forwarding faxes and TSI-sorted received faxes. The increase in storage destinations for received faxes will further promote a paperless environment.

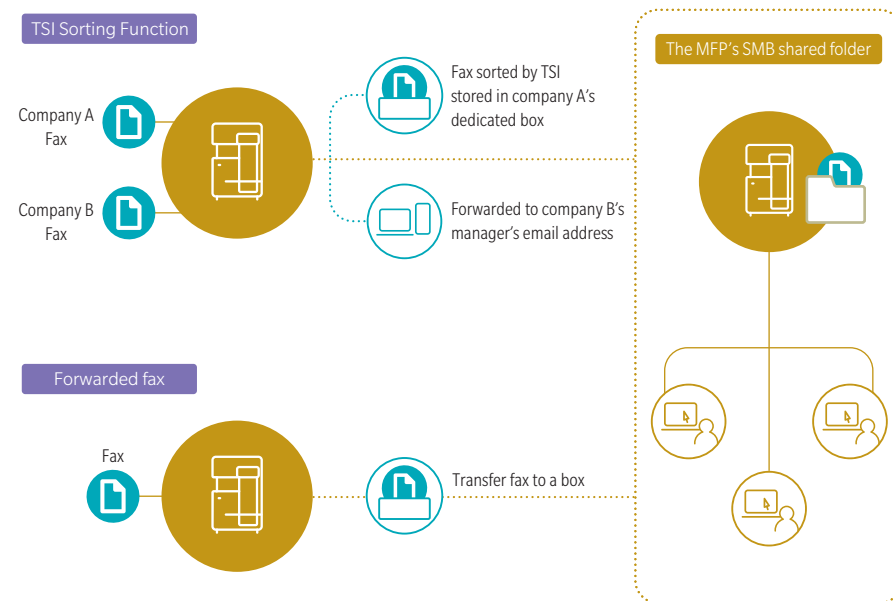

## Digitisation of paper documents

Documents can be scanned and converted to PDF or OOXML format files. File format can be selected according to the business and intended use, which broadens the scope of secondary use.

### Scan to PDF / Scan to OOXML image (with LK-110 v2 installed)

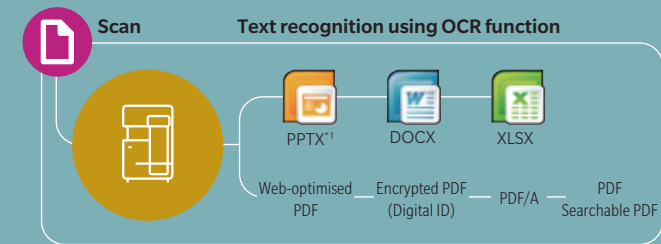

- Applying OCR to a document produces searchable text
- Microsoft Office etc. enables reuse of images and text.

### File conversion formats and required options (i-Option)

	LK-102 v3	LK-105 v4	LK-110 v2
PDF/A (long-term archiving)	✓		✓
Web-optimised PDF (linearised PDF)	✓		✓
Encrypted PDF (digital ID)	✓		✓
Searchable PDF (OCR)		✓	✓
OOXML file			✓*1
(extension: docx/.xlsx/.pptx) conversion			✓
OOXML file		✓*2	✓
(extension: docx/.xlsx/.pptx) conversion +OCR			✓

\*1 pptx conversion is a standard function, but the OCR function requires either LK-105 v4 or LK-110 v2.  
\*2 Only compatible with pptx.

## Improve scan job efficiency

Scanned originals can be converted to a variety of document formats according to the application and stored in the bizhub's box or a USB flash drive. They can also be sent and stored to a PC or server via email, SMB, FTP, or Web DAV.

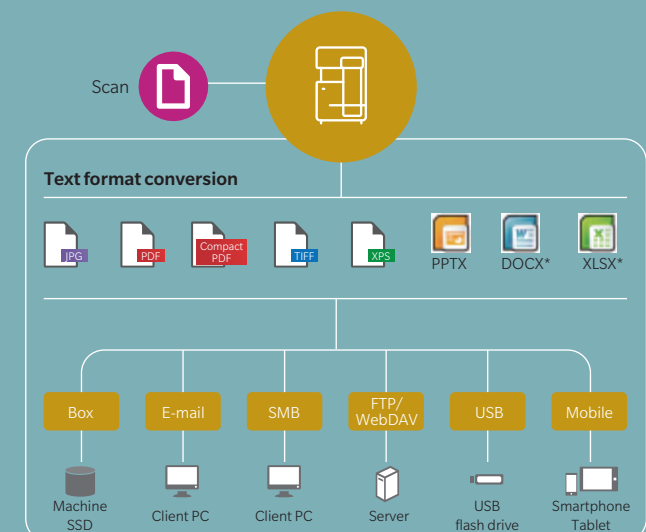

\* Requires i-Option LK-110 v2

## Other main scan and fax functions

- A Super G3 Fax is standard equipment
- Direct Fax, paperless sending from a PC
- Convert received data into a Searchable PDF format  
\*Requires i-Option LK-110 v2.
- Supports "W-NET Fax" a broadly compatible internet fax
- IP Address Fax reduces transmission costs
- Address Storage for a maximum of 2000 addresses (100 groups)
- Skip Blank Pages function skips blank originals during scanning.
- Banner Scan scans long originals from the ADF

## Task Automation Tools

\*Sold separately

### Dispatcher Phoenix

Dispatcher Phoenix automates digitised document processes from file aggregation to processing and distribution. By dividing processes via pre-set conditions, such as OCR processing, file renaming and barcode scanning, each document is automatically stored at a destination. This delivers one-touch execution of cumbersome tasks. Start times can be scheduled so that digitised tasks can be executed quickly and efficiently. Broad scalability and versatility, including connectivity with cloud services, enable creation of flexible workflows tailored to the customer's business and office environment.

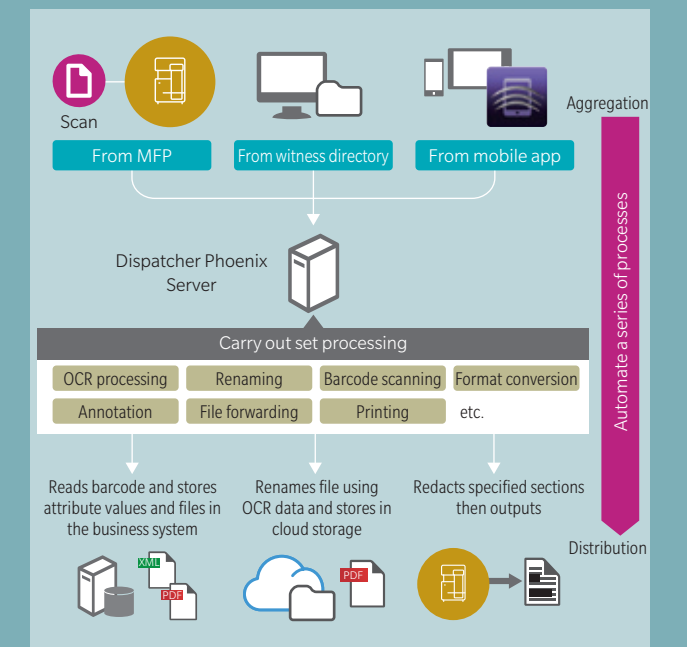

\* Some functions are only compatible in Classic Mode.

# MOBILE

Offers a new workstyle through advanced connectivity with mobile devices.

## Mobile communications function

### Connectivity with NFC-equipped Android devices

The operation panel has a mobile touch area compatible with NFC-equipped devices. Installing Konica Minolta Mobile Print on Android devices allows that device to be registered to bizhub. Just holding the Android device over the mobile touch area enables the selected file to be printed. Originals set in bizhub can also be scanned and saved to Android devices or cloud storage. Where user authentication is enabled, just holding the Android device nearby allows log in.

\*Requires the Android device to be equipped with OS4.4 or later.  
\*Requires a wireless LAN environment.

### Bluetooth LE connectivity with iOS devices

Using Bluetooth LE (low energy), a bizhub close to the user can be searched and registered with Konica Minolta Mobile Print. As it is also supported with the iOS action button, printing and scan data sharing from various applications can be smoothly executed. Further, where user authentication is enabled, Bluetooth LE can be used to log in.

\*Requires the device connection I/F kit EK-P09 option.  
\*Requires wireless LAN environment.



## Wireless LAN (AP Mode)

bizhub C4050i series supports Simple AP Mode\*, which easily creates a local wireless LAN environment with only the bizhub allowing a wireless LAN to be built separately from the company LAN. Because it bypasses the company LAN, even mobile devices brought in from outside can be securely connected.

\*Requires Upgrade Kit UK-221 option.

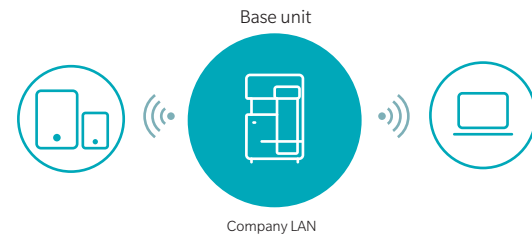

## Supporting a range of print services



**Konica Minolta Mobile Print**  
This is a mobile application offered by Konica Minolta. With a simple and intuitive user interface, connecting a mobile device with bizhub allows fast, secure scan data acquisition, saving to and sharing cloud storage, as well as document and image printing. Authentication Print and Secure Print are also supported enabling worry-free printing of confidential documents.



**AirPrint**  
Apple's standard printing system which is supported from IOS4.2 and Mac OS X 10.7. Supported printers can be used via wireless LAN without installing applications on devices.



**Mopria Print Service**  
Wireless technology offered by Mopria Alliance allows printing from devices equipped with Android 4.4 or later version.



**Google Cloud Print**  
Printing can be executed from various locations via the Internet, regardless of OS or device, as long as the app is supported with Google Cloud Print.

\*Requires Google Cloud Print Setup and Google account registration.



**Konica Minolta Print Service**  
Direct printing via wireless LAN to bizhub from any device with Android 4.4 or later version.

# ECO FRIENDLY

A range of environmental considerations made, from outer case materials to power consumption.

## Adoption of recycled materials

Konica Minolta has further refined our original chemical processing technology, which now uses recycled PC/PET for exterior and interior materials. As a result, use of recycled materials has increased to about 60%, as a surface area ratio. Proactive adoption of recycled materials contributes to effective use of resources and promotes corporate environmental protection.

\*PCR (post-consumer recycling) ratio: is the proportion of materials collected in the municipality used in recycled materials.

## 0.5W sleep mode power consumption

Power saving logic has been improved, including turning off the CPU during sleep mode, to reduce sleep mode power consumption to 0.5W. In addition to helping reduce environmental impact, this is also effective in reducing TCO (Total Cost of Ownership).

## An original Green Products Certification System

One of Konica Minolta's initiatives to reduce environmental impact is the establishment of its original Green Products Certification System that evaluates product environmental performance. bizhub C4050i series has been certified as Green Products. In working towards a sustainable society, by setting such rigorous standards on our own products, Konica Minolta is striving for environmentally considerate technological innovation.



The Blue Angel (Germany)



Eco Mark (Japan)

## CO<sub>2</sub> emissions reduction

bizhub C4050i series features a power saving design that easily clears TEC values stipulated in the International Energy Star Program Version 2.0. Compared with the previous model, TEC values have been broadly reduced by about 24%. This reduction in TEC values has also significantly reduced CO<sub>2</sub> emissions.

### TEC value comparison between previous model and bizhub C4050i series

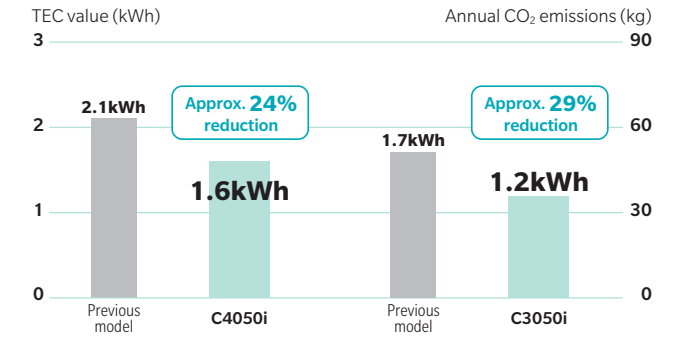

\*TEC value from International Energy Star Program Ver. 2 application  
\*Annual CO<sub>2</sub> emissions (TEC value x 1 year (52 weeks) x emission factor).  
From November 2012 Press release by the Ministry of the Environment

## Wide-ranging environmental compatibility. Compliant with various environmental standards

To address environmental issues such as global warming, our products are compatible with global environmental standards, including the International Energy Star Program which aims to develop and introduce highly energy-efficient office equipment.



The Blue Angel (Germany)



Green Purchase (Japan)



RoHS (EU)



EcoLeaf (Japan)

