

Giving Shape to Ideas

bh958 B&W 95 ppm	bh758 B&W 75 ppm	Resolution 1,200 dpi	SRA3
Dual Scan ADF 240 opm Duplex	Dual Scan ADF 120 opm Simplex	USB Print	Fax *1
Colour Internet Fax	IC-Card Authentication *1	Biometric Authentication *1	INFO-Palette
Mobile Support	AirPrint	Google Cloud Print Ready	PRINT WITH ANDROID
mopria	KMPS	Bioplastic	Recycled PC/PET
Emperon Driven!	PageScope Mobile	Simitri with Biomass	



bizhub 958/758 Specifications

Printer Specifications

Type	Embedded
CPU	MB86572 (1.6GHz)
Memory	4 GB
Print Speed	Same as Copy Speed (when using the same original)
HDD	250GB
Print Resolution	1,800 dpi (equivalent) x 600 dpi (at smoothing) or 1,200 dpi x 1,200 dpi (in 1,200 dpi mode)*1
PDL	PCL5e/c Emulation, PCL6 (XL ver. 3.0) Emulation, PostScript 3 Emulation (3016), XPS (Ver. 1.0)
Protocol	TCP/IP (LFD, Raw, SMB, IPP), AppleTalk, IPX/SPX
Support OS	PCL Windows Vista** / 7** / 8.1** / 10** Windows 2008** / 2008 R2 / Server 2012 / Server 2012 R2
	PS Windows Vista** / 7** / 8.1** / 10** Windows 2008** / 2008 R2 / Server 2012 / Server 2012 R2 Mac OS X 10.7 / X 10.8 / X 10.9 / X 10.10 / X 10.11 (Intel)
	XPS Windows Vista** / 7** / 8.1** / 10** Windows 2008** / 2008 R2 / Server 2012 / Server 2012 R2
Fonts	PCL European 80 fonts
	PS European 137 fonts
Interface	Ethernet (100BaseT/1000BaseTX/10BaseT), USB 2.0 / 1.1

*1 Output speed will be reduced.
*2 Supports the 32bit (x86) or 64bit (x64) environment.

Scanning Function Specifications

Type	Full-Colour Scanner
Interface	Ethernet (100Base-T/1000Base-TX/1000Base-T)
Driver	TWAIN Driver, HDD TWAIN Driver
Protocol	TCP/IP (FTP, SMB, SMTP, WebDAV) (IPv4/IPv6)
Scanning Speed**	Simplex 120 opm Duplex 240 opm
Scanning Size	Max. A3 (11" x 17")
Output Format	TIFF, JPEG, PDF, Compact PDF, XPS, Compact XPS, OOXML (pptx, xlsx*, docx*), Searchable PDF*, PDF/A*, Linearised PDF**
Scanning Resolution	Push 200 dpi / 300 dpi / 400 dpi / 600 dpi Pull 100 dpi / 200 dpi / 300 dpi / 400 dpi / 600 dpi
Main Functions	Scan to E-Mail, Scan to FTP, Scan to BOX (HDD), Scan to PC (SMB), Network TWAIN, Scan to WebDAV, Scan to Me, Scan to Home, Scan to USB, Scan to Scan Server, Scan to Web Service (WSD-Scan), Device Profile for Web Services (DPWS)
Other Functions	Multi-Method Send, Authentication at the time of E-Mail send (SMTP authentication, POP before SMTP), S/MIME, Annotation
Supported operating systems**	Windows Vista / 7 / 8.1 / 10

*1 Speed when scanning A4 original in 300 dpi or less by using the ADF.
*2 Optional
*3 Supports the 32bit (x86) or 64bit (x64) environment.

General Specifications

	bizhub 958	bizhub 758
Type	Console	
Copy	Scan	
Resolution	Print	
Gradation		
Memory size		
HDD		
Original Type		
Max. Original Size		
Output Size		
Image Loss		
Warm-Up Time** (23°C, std. voltage)		
First Copy Out Time**		
Copy Speed (A4)		
Magnification		
Paper Capacity		
Paper Weight**		
Multiple Copy		

Auto Duplex	Paper Size	SRA3, A3 to A5, B6**, A6** 12-1/4" x 18" (A3 wide (311.1 mm x 457.2 mm)), 12" x 18" (A3 wide (304.8 mm x 457.2 mm)), 11" x 17" to 5-1/2" x 8-1/2", 7-1/4" x 10-1/2", 8" x 13", 16K, 8K, Postcard (A6 (4" x 6" Card))
	Paper Weight	52 to 256 g/m ²
Power Requirements		AC220 to 240 V 10 A (50/60 Hz) 15 A (50/60 Hz)
Max. Power Consumption		3.6 kW or less 2.1 kW or less
Dimensions (W) x (D) x (H)		670 x 820 x 1,232 mm (26-3/8" x 32-5/16" x 48-1/2") *Main unit + ADF
Weight		Approx. 200 kg (440-15/16 lb)
Space Requirements (W) x (D)**		1,008 x 1,419 mm (39-11/16" x 55-7/8")

*1 SRA3 paper can be used in Tray2.
*2 There are four types of footcops: 8-1/2" x 13-1/2", 8-1/2" x 13", 8-1/4" x 13", and 8" x 13". Any one of these sizes is selectable. For details, contact your service representative.
*3 Long edge feed
*4 Short edge feed
*5 There are six types of footcops: 8-1/2" x 13-1/2", 220 mm x 330 mm, 8-1/2" x 13", 8-1/4" x 13", 8-1/8" x 13-1/8", and 8" x 13". Any one of these sizes is selectable. For details, contact your service representative.
*6 Wrinkles or printing errors may occur due to the type, storage or environment that exists when envelope printing is carried out.
*7 Printing on banner paper can only be performed from a PC.
*8 May vary depending on the operating environment and usage.
*9 A4 long edge feed full size/using the first tray/scanning from the original glass surface.
*10 With options installed.
*11 If paper of 210 g/m² or more is used, the resulting image quality may not be as expected.
*12 This shows the dimensions when the Paper Trays are pulled out and the Tray Extension of the Bypass Tray is opened.

Dual Scan Document Feeder

Type	Dual Scan Document Feeder
Support Paper Size	Max. A3 (Fax mode: Max. 1,000 mm)
Mixed Size	Support
Original Set	Centre guide
Support Paper Weight	Thin paper: 35 to 49 g/m ² (Simplex) Plain paper: 50 to 210 g/m ² (Simplex/Duplex), 50 to 128 g/m ² (Mixed Original)
Paper Capacity	Max. 300 sheets (80 g/m ²)
Productivity**	Simplex Colour/B&W: 80 opm Duplex Colour/B&W: 160 opm
Power Requirements	Supplied from the MFP main body
Dimensions (W) x (D) x (H)	618 x 575 x 180 mm (24-5/16" x 22-5/16" x 7-1/16")
Weight	Approx. 15.1 kg (33-5/16 lb)

** When copying A4, resolution 600 dpi.

Fax Kit FK-516, Fax Kit FK-515 (Optional)

Communication	Super G3
Compatible Lines	Public Switch Telephone Network, Private Branch Exchange, Fax Communication Line
Line Density	G3 (8 dot/mm x 3.85 line/mm, 600 x 600 dpi)
Modem Speed	2.4 to 33.6 kbps
Compression	MH/MR/MMR/JBIG
Sending Paper Size	Max. A3 (Long Length Support: Max. 1,000 mm)
Recording Paper Size	Max. A3 (Long Length Max. 1,000 mm - following the page division)
Transmission Speed	Less than 3 sec. (A4, V34, 33.6 kbps, JBIG)
Memory	Shared with the copier
Number of Abbr. Dials	2,000
Number of Program Dials	400
Number of Group Dials	100
Sequential Multiple Station Transmission	Max. 600

Large Capacity Unit LU-303 (Optional)

Support Paper Type (Weight)	Thin paper (52 to 59 g/m ²), Plain paper (60 to 90 g/m ²), Thick paper (91 to 256 g/m ²)
Support Paper Size	A4*, 8-1/2" x 11" **
Paper Capacity	Plain paper: 3,000 sheets (80 g/m ²)/3,300 sheets (60 g/m ²) Thick paper 1: 2,500 sheets, Thick paper 1+: 1,750 sheets, Thick paper 2: 1,550 sheets, Thick paper 3: 1,300 sheets
Power Requirements	Supplied from the MFP main body
Max. Power Consumption	40 W or less
Dimensions (W) x (D) x (H)	367 x 528 x 405 mm (14-7/16" x 20-13/16" x 15-15/16")
Weight	Approx. 18 kg (39-11/16 lb)

*1 Long edge feed
*2 Thick paper 1: 91 to 120 g/m², Thick paper 1+: 121 to 157 g/m², Thick paper 2: 158 to 209 g/m², Thick paper 3: 210 to 256 g/m²

Large Capacity Unit LU-205 (Optional)

Support Paper Type (Weight)	Thin paper (52 to 59 g/m ²), Plain paper (60 to 90 g/m ²), Thick paper (91 to 256 g/m ²)
Support Paper Size**	SRA3 to A4, 12" x 18" to 8-1/2" x 11"
Paper Capacity	Plain paper: 2,500 sheets (80 g/m ²)/2,750 sheets (60 g/m ²) Thick paper 1: 2,000 sheets, Thick paper 1+: 1,450 sheets, Thick paper 2: 1,250 sheets, Thick paper 3: 1,000 sheets
Power Requirements	Supplied from the MFP main body
Max. Power Consumption	40 W or less
Dimensions (W) x (D) x (H)	629 x 556 x 405 mm (24-3/4" x 21-7/8" x 15-15/16")
Weight	Approx. 25 kg (55-1/8 lb)

*1 The maximum number of loadable sheets for each paper size is 2,500 sheets (for 80 g/m²) or 2,750 sheets (for 60 g/m²).
*2 Thick paper 1: 91 to 120 g/m², Thick paper 1+: 121 to 157 g/m², Thick paper 2: 158 to 209 g/m², Thick paper 3: 210 to 256 g/m²

For more information please visit the bizhub Web site at
<http://bt.konicaminolta.in/bizhub-958-758-product-overview/>

Product Appearance, Configuration And/or Specifications Are Subject To Change Without Notice.

KONICA MINOLTA, the KONICA MINOLTA logo and symbol mark, "Giving Shape to Ideas", bizhub, bizhub PRO, bizhub PRESS, magicolor, PagePro, PageScope, Simitri, Simitri HD, Simitri HD+, Simitri with Biomass, Emperon, S.E.A.D., S.E.A.D.II, Printgroove and Konica Minolta Optimised Print Services and their respective logos are registered trademarks or trademarks of KONICA MINOLTA, INC. Evenote is a registered trademark or trademark of Evenote Corporation. SharePoint is a registered trademark or trademark of Microsoft Corporation in the U.S. and other countries. All other brands and product names are registered trademarks or trademarks of their respective companies or organisations.



Ecology & Environment

KONICA MINOLTA products are designed with the environment in mind.

- Energy Star
- RoHS Compliance
- WEEE Compliance
- Eco-friendly Toners



- REQUIREMENTS FOR SAFE USE**
- Please read and follow the instruction manual to ensure safe operation.
 - Only operate using appropriate power supply and voltage.
 - Connecting the earth wire to an inappropriate place may cause explosion or electric shock. Please connect accordingly.

For more information: SMS "KM OFFICE" send to 52424 or Call: 1-800-266-2525
Konica Minolta Business Solutions India Pvt. Ltd. : 10th Floor, Building No.8, Tower C,
DLF Cyber City, Phase II Gurgaon, Haryana - 122002, India. Board No. +91-124 6652000.
URL: www.konicaminolta.in, marcom@bin.konicaminolta.in | Konica Minolta Inc., Tokyo, Japan.
Connect with us :



Contact Point:



KONICA MINOLTA

PRODUCTIVITY
BEYOND IMAGINATION
PERFORMANCE
ABOVE EXPECTATION

A3 B&W Multifunctional Printer

bizhub 958/758



To Connect with iOS Devices

Search and register nearby MFP into the PageScope Mobile (PSM)[™] via Bluetooth LE (BLE)[™] technology. Additionally, iOS devices can be used to login to MFP through BLE connection. Select files on the PSM[™] to print directly from iOS devices[™] or scan files directly to the iOS devices.

[™]PageScope Mobile for iPhone/iPad version 5.0 or higher is required.

[™]Optional Local Interface Kit EK-611 is required.

[™]Wireless LAN environment is required to perform print and scan.

To Connect Instantly Without Print Drivers to the Industry Standard Mobile Technologies

iOS



AirPrint
iOS and Mac OS X standard printing technology.

Android

Mopria Print Service
Multi-vendor-compatible application supplied by Mopria Alliance.



Android

Mopria Print Service
Application that enables mobile printing from bizhub.



Google Cloud Print

Enable printing via Cloud from Google Cloud Print supported application.

* Google Cloud Print Setup and Google account registration are required.



PageScope Mobile

Mobile application supplied by Konica Minolta that enable a wide range of bizhub functions including print, scan, staple and punch.



Windows 10 Mobile

Wireless LAN (AP mode) Support

The MFP becomes a wireless LAN Access Point[™] to allow direct wireless connection between mobile devices and bizhub. Devices brought into the office will be able to directly connect with bizhub and are securely separated from existing company LANs. PageScope Mobile will enable more convenient use, as wireless set up can be completed between a mobile device and bizhub simply by reading the QR code that is displayed on the machine panel.

[™]Optional Upgrade Kit UK-212 is required.

Advanced security function indispensable when handling increased volumes of input and output

Authentication on the MFP Main Unit

Authentication can be performed directly on the main unit. Detailed access control can be set up for each function including copy, print, scan, and fax[™].

[™]Optional FAX Kit FK-516 is required.

IC Card Authentication

To authenticate[™] with various types of IC card[™]. The authentication method is also compliant with SSFC (Shared Security Formats Cooperation) standard. Besides the IC card, authentication can also be performed with any Android devices[™] that is equipped with NFC antenna.

[™]Optional Authentication Unit AU-2015 is required.

[™]Compliant non-contact IC cards include FeliCa (iDm), SSFC, FCF, FCF (campus), FeliCa Private, and MIFARE (UID).

[™]Requires Android 4.4 or later that supports HCE (Host Card Emulation) or PageScope Mobile for Android v4.1 or later.

Biometric Authentication

The finger veins become the most accurate authentication tool. The biometric authentication is easy to implement but offering very high-level security.



* Optional Biometric Authentication Unit AU-102, Working Table WT-506 or WT-513 are required.

Server-less pull printing

Print jobs sent by user can be printed from any MFP in the office print group. To allow user to build a server-less pull printing system easier and with low introduction cost.

* A pull printing system consisting of a maximum of 10 MFPs can be created. It is necessary that all corresponding MFPs be in the same network.

* Optional i-Option LK-114 are required to be installed to each of the MFP.

High productivity that is ideal for CRDs and High-volume Offices

Faster Printing Speed

This series achieves significantly fast print/copy speed of 95/75 ppm[™]. This answers to CRDs and high-volume offices' requirement of a speedy large-volume output. Shortening output time enables effective use of time and manpower, resulting in efficiency and cost reduction.



* Printing speed for 958: 95 sheets ppm, 758: 75 sheets ppm (A4 horizontal)

Simplicity and usability to fit any working environment

Product Design

The bizhub 958 series adopts "easy and intuitive INFO-Palette" design with smart user interface. This unified design ensures similar user experience across PCs, tablets or smartphones.



9-inch Multi Touch Panel

The operation screen features a large anti-static 9-inch multi-touch panel. Frequently used functions can be registered flexibly to enhance the office work performance. A built-in widget function enables to post a textbox, icon or GIF animation.

Allowing in-house production and faster document handling with multiple functions

Plenty of Paper Feed Options

The standard paper capacity of the MFP is 3,650 sheets. The optional Large Capacity Unit (maximum of 6,650[™] sheets) improves productivity and reduces paper replenishment time.

[™]When optional Large Capacity Unit LU-303 are mounted.

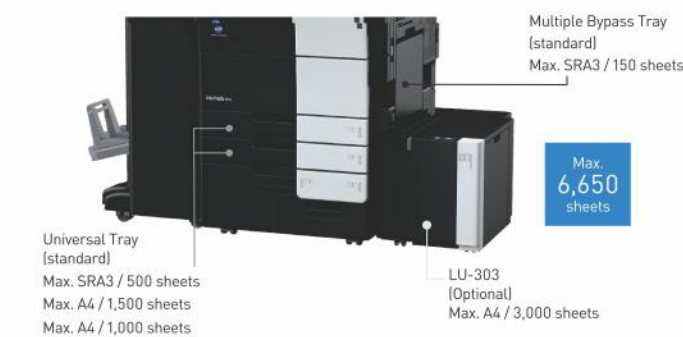

[™]The paper supply capacity for all models is based on 80g/m2.

Large Capacity and High-Speed ADF

A single pass document feeder is mounted as standard, and it enables 240 opm[™] scanning in colour. Up to 300 original documents can be loaded. Advanced scanning technology enhances scan quality and a large volume of scanning job can be processed quickly.

120 opm for simplex documents

240opm for duplex documents

[™]At 300dpi, 2-sided



Finisher [FS-537/FS-5375D][™]

The compact and multi-function finisher [FS-537/FS-5375D] is newly developed, and a Z-fold unit [ZU-609] can fit into the finisher. FS-537/FS-5375D is capable of handling a wide range of post-processing like saddle-stitch, punch, staple, Z-fold and tri-fold to provide a high-quality finish.

[™]Optional

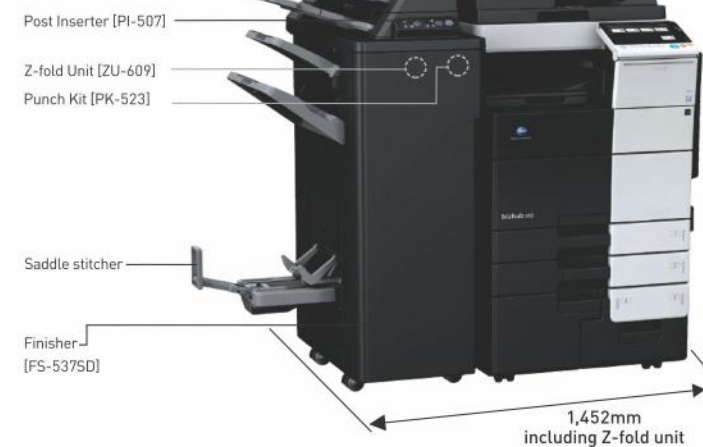

Document Digitalisation

Paper documents can be scanned and converted into PDF and OOXML (pptx, docx, xlsx) file formats. Choose a file format suitable for the work objective to widen the potential of documents for secondary usage.

Image of Scan to PDF and Scan to OOXML (when LK-110 v2 is mounted)

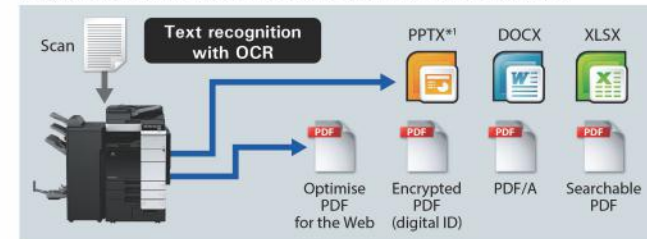

* OCR processing enables text searching.
* Images and text can be reused in applications such as Microsoft Office.
* Although pptx conversion is a standard function of this machine, optional i-Option LK-105 v4 or LK-110 v2 are required to use OCR.

Not just heavy use but flexible mobile connectivity

To Connect with Android Devices

The new Mobile Touch Area on the operation panel is ready to support NFC (Near Field Communication) connection with Android[™] devices. Touch the area with Android device to perform pairing through the PageScope Mobile (PSM). Select files on the PSM, then touch the device to the operation panel to perform print[™] or touch the device to the operation panel to perform scan[™].

[™]NFC connection requires Android OS 4.4 or higher to be installed.

[™]Wireless LAN environment is required to perform touch to print and scan.



Job Separator JS-602*1

When attached to the FS-537/FS-5375D, this becomes the fax/print/copy output separator tray.

Post Inserter PI-507*1

When attached to Finisher FS-537/FS-5375D, allows you to add white paper cover sheet/inter sheet, and operate the Finisher

*1 PI-507 and JS-602 cannot be installed at the same time

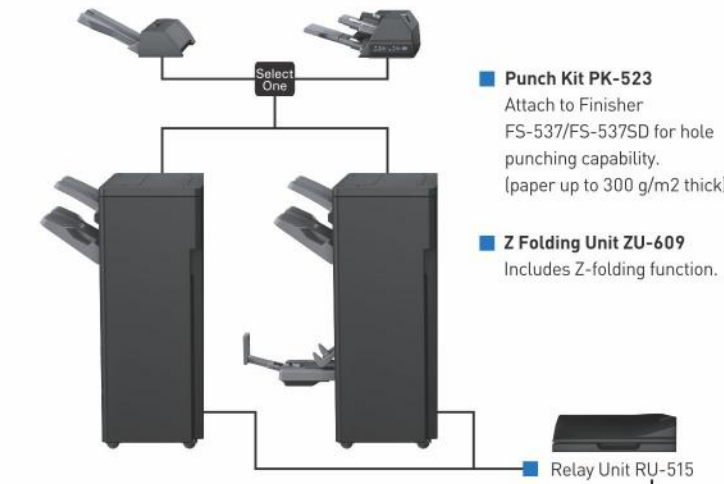

Punch Kit PK-523

Attach to Finisher FS-537/FS-5375D for hole punching capability. (paper up to 300 g/m2 thick)

Z Folding Unit ZU-609

Includes Z-folding function.

Finisher FS-537

A high-performance finisher that allows you to multi-staple up to 100 sheets.

Finisher FS-5375D

A high-performance finisher that allows you to multi-staple, saddle stitching, half folding and tri-folding.

Relay Unit RU-515

Staple Kit MS-10A

* for FS-537/FS-5375D

Staple Kit SK-602

* for FS-536/FS-536SD/FS-5375D

Punch Kit PK-520

Attach to Finishers FS-536/FS-536SD for hole punching capability (paper up to 300 g/m2 thick)

Finisher FS-536

A small, low-noise and high-performance finisher that allows you to multi-staple up to 50 sheets.

Finisher FS-536SD

A small, low-noise and high-performance finisher that allows you to multi-staple, saddle stitching, half folding and tri-folding.

Upgrade kit UK-212

Wireless LAN kit

Local Interface Kit EK-610

USB hub kit / Voice guidance

Local Interface Kit EK-611

USB hub kit / Voice guidance / mobile phone compatibility

Keypad KP-101

Keyboard Holder KH-102

Security Kit SC-508

* Two SC-508 are required.

Fax Kit FK-516

For 1st / 2nd line

Fax Kit FK-515

For 3rd / 4th line

* MK-742 is required.

Fax Mount Kit MK-742

Stamp Unit SP-501

Hard Disk HD-524 For Mirroring

For ADF

Double Feed Detection Kit UK-501

For ADF

Working Table WT-513

For Upright Panel

Working Table WT-506

Authentication Unit AU-102

Biometric type

* WT-506 or WT-513 is required.

Authentication Unit AU-2015 IC card type

WT-506 or MK-735 is required. However, AU-102 cannot be combined when equipped with WT-506.

Mount Kit MK-735

For IC card authentication installationBuilt into front pane

Banner Paper Setting Guide MK-715

Used for banner printing.

Output Tray OT-508

Large Capacity Unit LU-205

Increases the bizhub's paper capacity by 2,500 sheets for paper up to SRA3 and 80 g/m2 thick.

Large Capacity Unit LU-303

Increases the bizhub's paper capacity by 3,000 sheets for paper up to A4 size and 80 g/m2 thick.

Select One One of the options may be selected (not mandatory)

Must Select One of the options must be selected (mandatory)

*Optional